

Janus G2 / G3

The No.1 Dash Board Camera for Fleet Management System



withCLOUD
3CH 3CH Smart Cloud Dash Cam



Janus G2 / G3



Bus

Van

Taxi

Truck

Trailer

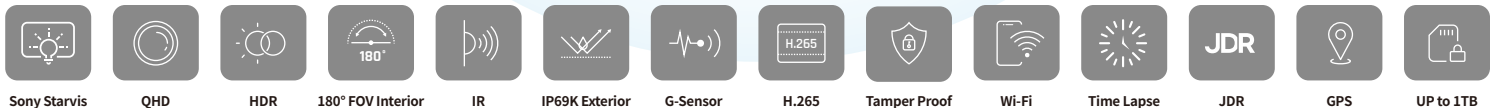

Technical Spec

CPU	Allwinner V536(Dual-Core Cortex-A7@1.2Ghz Processor)
Memory	4GB DDR SDRAM
Camera	<p>Front QHD@30 fps, 140° FOV, SONY Starvis IMX 335 HDR</p> <p>Interior FHD@30 fps, 180° FOV, SONY Starvis IMX 307, IR</p> <p>Rear FHD@30 fps, 140° FOV, SONY EXMOR IMX 323</p> <p>Exterior FHD@30 fps, 140° FOV, SONY EXMOR IMX 323, IR, IP69K</p>
Video / Audio	H.265/ADPCM Built-in speaker and Microphone
Storage	Micro SD Card up to 1TB (Recommended type : MLC, Class 10)
G-Sensor	Triaxial acceleration sensor
Power	DC 12V - 24V, about 6.8W based on 12V Constant power : Low voltage cutoff and boot voltage setting
Connectivity	Dongle type Wi-Fi, External GPS LTE Cat. 4 and Cloud service supported "withCLOUD" supported - CLOUD service
OBD II	Supported(Read Vehicle Information, System diagnosis, Engine system statistics)
Recording	Normal, Impact, Parking, Motion Detection, Voice Record

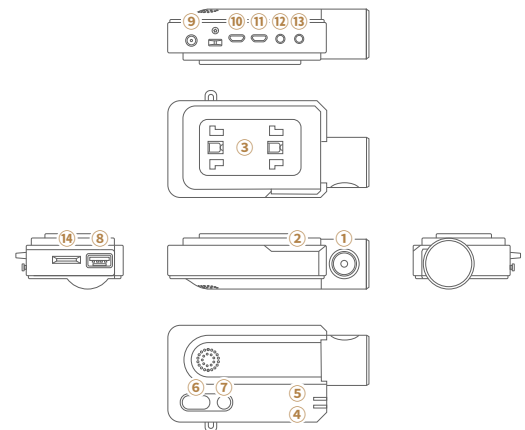

- ① Front Camera Lens
- ② Security LED
- ③ Front Cam Bracket
- ④ GPS LED
- ⑤ REC LED
- ⑥ Wi-Fi Connection Button
- ⑦ Power Button
- ⑧ Wi-Fi USB Port
- ⑨ Power Connector (DC-IN)
- ⑩ Interior Camera Port
- ⑪ Rear Camera Port
- ⑫ External GPS Connector
- ⑬ OBD2 Connector
- ⑭ Micro SD Card Slot

Rear Cam



Interior Cam



Exterior Cam



Resolution / Frame per seconds	1080P(1920 x 1080P), Max 30FPS, 140°	1080P(1920 x 1080P), Max 30FPS, 180°	1080P(1920 x 1080P), Max 30FPS, 140°
Image Sensor	SONY IMX323 EXMOR 2MP CMOS Sensor	SONY IMX307 STARVIS 2MP CMOS Sensor	SONY IMX323 EXMOR 2MP CMOS Sensor

Janus G2 / G3

Various Applications with G-Model Camera

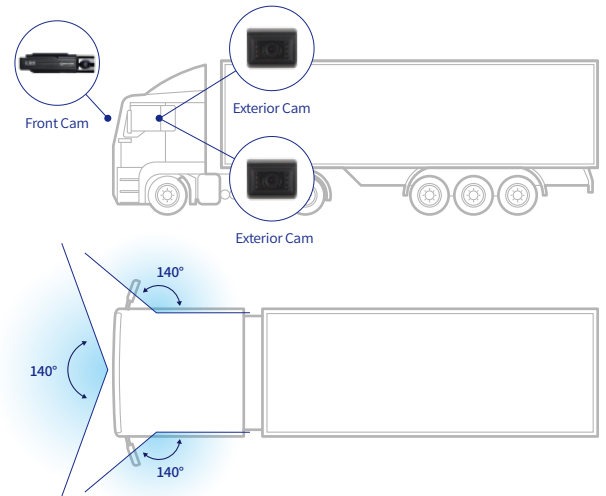
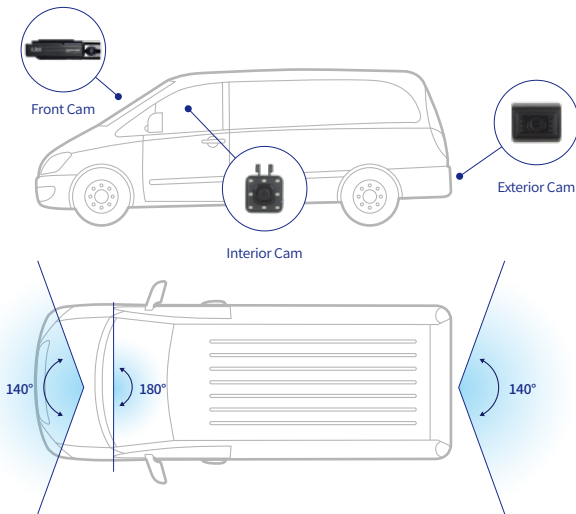
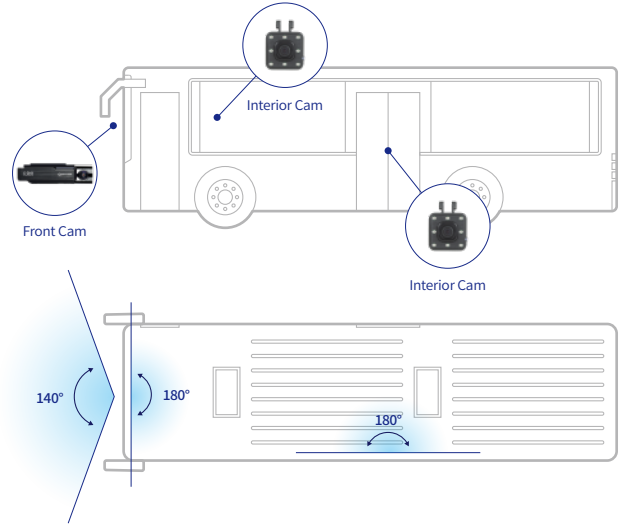
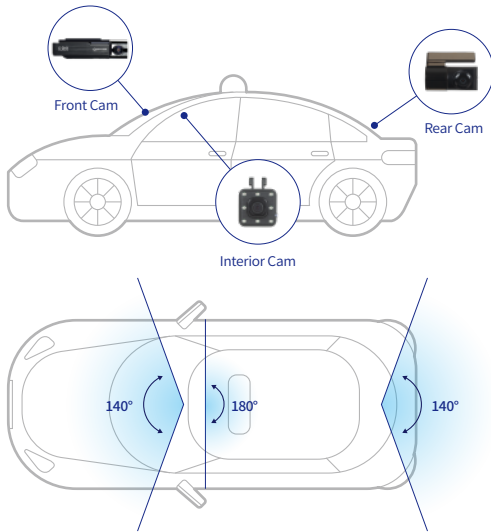

G-Model Recording Time Table

	2 fps	5 fps	10 fps	15 fps	20 fps	25 fps	30 fps
16GB	753.3 min	485.5 min	240.1 min	166.8 min	127.0 min	103.0 min	86.3 min
32GB	1506.6 min	970.9 min	480.1 min	333.5 min	254.0 min	206.1 min	172.7 min
64GB	3013.1 min	1941.8 min	960.2 min	667.0 min	508.0 min	412.2 min	345.4 min
128GB	6026.3 min	3883.6 min	1920.5 min	1334.1 min	1016.1 min	824.4 min	690.8 min
256GB	12052.6 min	7767.2 min	3840.9 min	2668.1 min	2032.1 min	1648.7 min	1381.5 min
512GB	24105.2 min	15534.5 min	7681.9 min	5336.3 min	4064.2 min	3297.4 min	2763.0 min
1TB	47080.5 min	30340.8 min	15003.7 min	10422.5 min	7937.9 min	6440.2 min	5396.5 min
Mbyte / Min	21.75	33.75	68.25	98.25	129	159	189.75

Janus G2 / G3

Various Applications with G2 / G3 Dash Camera



withCLOUD
SYSTEM Smart Cloud Dash Cam

Special Features

· Tamper Proof

Tamper Proof Cover Installation

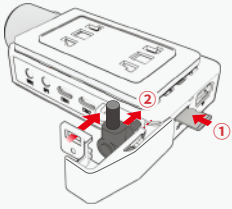

1) Insert a micro SD card in ① and connect the power cable to ②. Then slide the SD cover into the hole as shown.

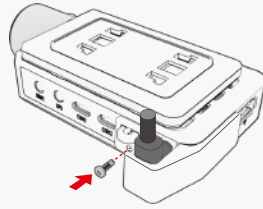

2) Fasten a screw firmly to put them together.

Seal Cable Installation

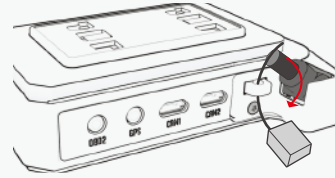

1) Hook up the cable to the protrusion on the body.

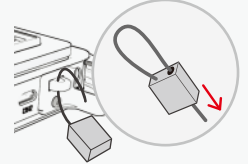

2) Bend and insert the end of the cable into the hole to lock it and adjust the length as required.

· 180° Interior Cam



- Sony Starvis IMX307 sensor
- Resolution 1920 x 1080p (Full HD) and max. 30 fps
- Infrared Camera
- Wide angle view of 180°

· OBD II support



- Read vehicle information
- System diagnosis
- Engine system statistics
- Database creation

· Cloud Support

Real Time Live View



GPS Tracking



Video / Image Upload



Geo-Fence



Statistics



Real Time Record View



- Real time live view
- On-line footage management (up/download)
- GPS tracking
- Geo-Fencing
- Vehicle management
- Statistics based on time, distance and events
- Server integration available with protocol (no SDK provided)

· Wi-Fi support



- User-focused firmware upgrade
- System configuration available
- Download recorded video
- Power management

· PC viewer



- Easy play and check recorded videos
- Easy plate number check via video magnification
- Video file converting and saving (JDR to MP4)
- Many adjustment options for G-ON3

Janus G2 / G3



Various Applications with G2 / G3 Dash Camera

Components of G-Model



Optional Product



2D Drawing

Front Camera

SIZE : 118(W) × 71(D) × 31(H) mm

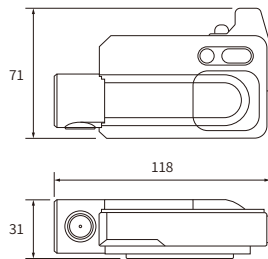

Rear Camera

SIZE : 59(W) × 31(D) × 39(H) mm

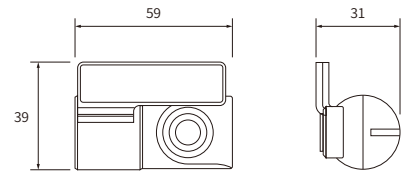

Interior Camera

SIZE : 47(W) × 27(D) × 74(H) mm

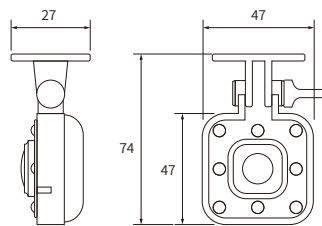

Exterior Camera

SIZE : 49(W) × 47(D) × 54(H) mm

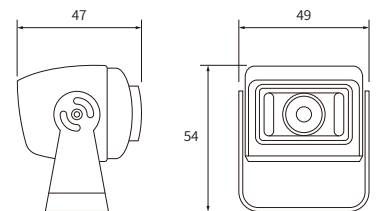

Flagship models

• Janus G2

Janus G3



You can contact us :

Peter Park / 650-871-8696 / peter.park@januscam.com

We provide the best experience with our products. Please visit our website

www.januscam.com



JANUS CAM